

# QIn Prestige speaker stand

## Manual

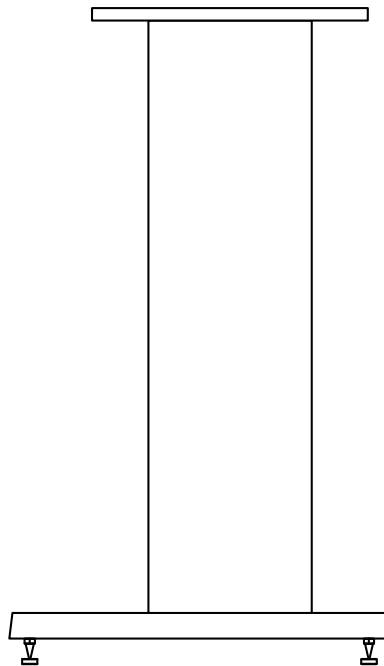

### Included:

- 2x Top plate 270x200x12mm
- 2x Bottom plate 372x265x25mm
- 2x Pillar 580x160x110mm
- 8x M6 spike
- 8x M6 nut
- 8x floor disk
- 8x Rubber disk
- 4x M6x30mm screws for top plate
- 4x M6x40mm screws for bottom plate
- 4x M6x40mm to mount speaker bottom plate as top plate
- 1x H4 Allen key

# Mounting instruction

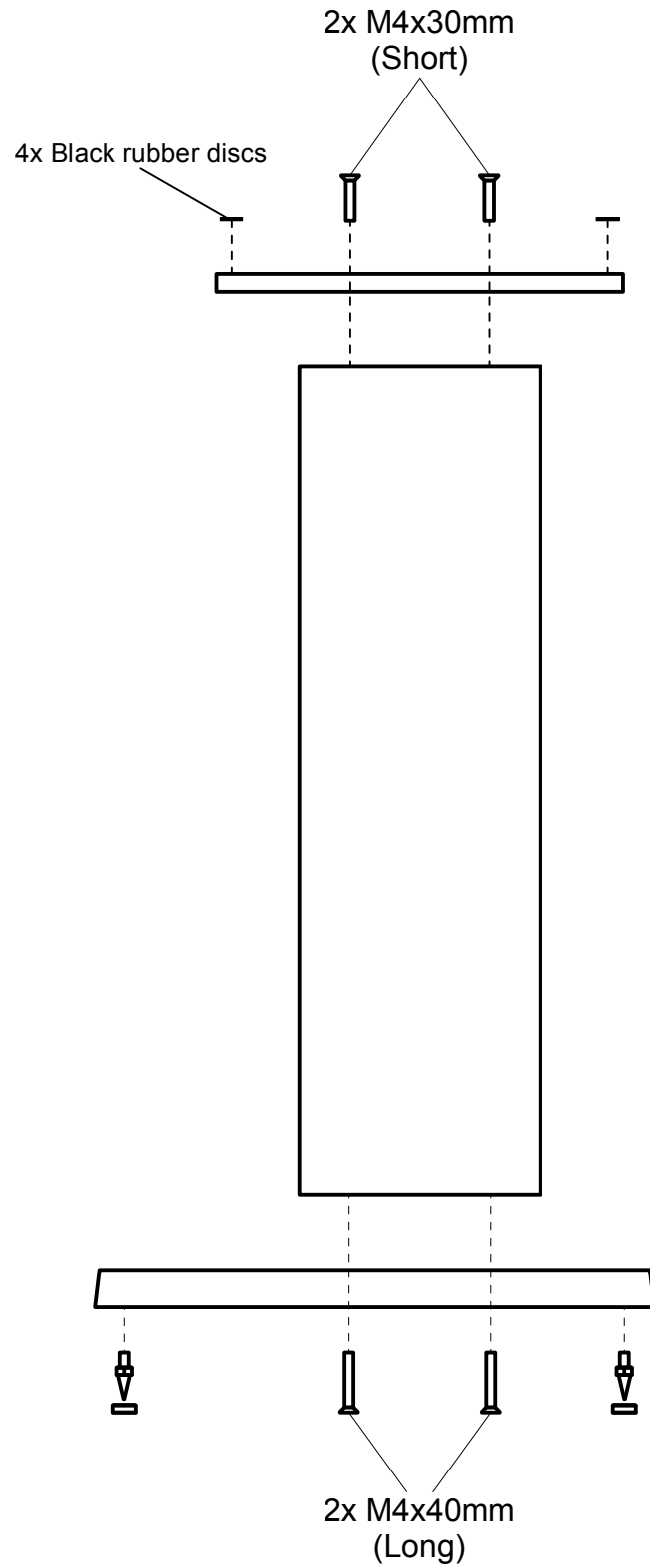

# Mounting instructions stand with Prestige Three speaker

1

Unscrew 4x M4x40 bottom screw

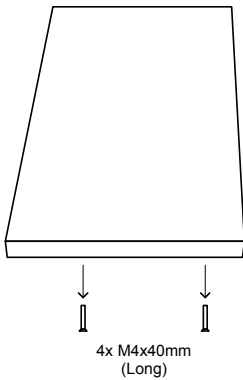

2

Dismantle speaker bottom plate

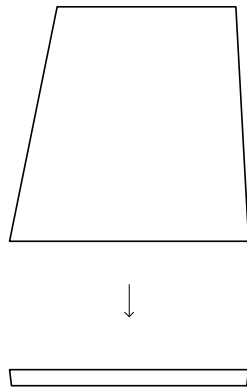

3

Mount speaker bottom plate to stand  
with new 2x M4x40 long silver screw

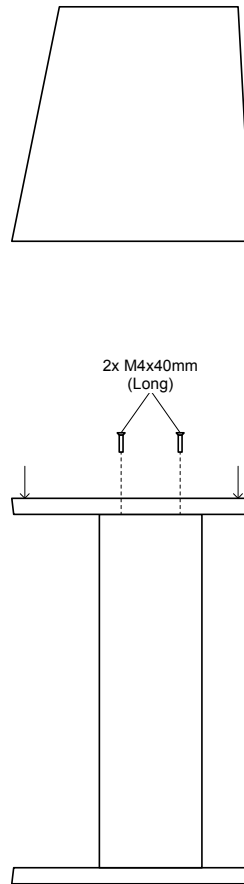

4

Remount speaker bottom plate  
to speaker with speaker original  
screws

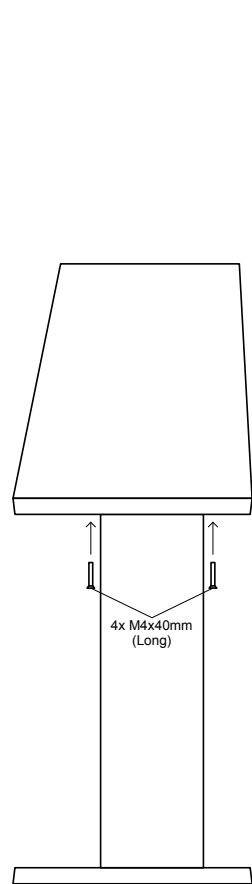

The 40mm big hole on pillar shall be at the top.  
The stand can be filled with 1/3 to 1/2 sand(dry) for increased damping and stability,  
when stand is mounted!

Hole  $\varnothing=40$  at top end for sand filling

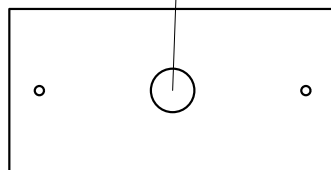

Important, empty sand before dismantling the stand!

